



*Century Cabinets*

form . function . forever .



A Complete Line of Multi-Family and  
Commercial Cabinets

[www.centurycabinetsinc.com](http://www.centurycabinetsinc.com)



*Value and durability  
where it is needed most.*

Century Cabinets Inc. is a manufacturer of  
high-quality cabinetry and cabinet products  
for use in multi-family and commercial  
building projects.

Century Cabinets, Inc  
ph 678-213-2299  
fx 678-213-2432  
[www.centurycabinetsinc.com](http://www.centurycabinetsinc.com)







*A complete turnkey solution.*

We are a complete turnkey cabinet source for apartments, condos, hospitality, assisted living and medical facilities.

From cabinets to countertops to installation, we offer a comprehensive package of products and services to meet the demands of any size commercial project.





*The most for your money.*

Century Cabinets produces durable and beautiful all-wood kitchen and bath cabinets from maple, birch, cherry and oak. We offer both traditional face frame and frameless European style cabinets. There are no limitations on styles or finish colors.

We provide maximum value to our clients by manufacturing and distributing and installing our own products, eliminating markups and controlling costs.

Century Cabinets, Inc  
ph 678-213-2299  
fx 678-213-2432  
[www.centurycabinetsinc.com](http://www.centurycabinetsinc.com)





An array of compelling combinations are available...

## Styles



*Buckingham  
Spice*



*Camden  
Ginger Glaze*



*Century  
Cherry Glaze*



*Chesapeake  
Port*



*Delaware  
Cognac Glaze*



*Hudson  
Antique White*



*Jackson  
Cinnamon*



*Madison  
Ginger Glaze*



*McKinley  
White*



*Monroe  
Hazelnut*



*Ridgeview  
Cinnamon Glaze*



*Shaker  
Natural*



*Venice  
Cherry*

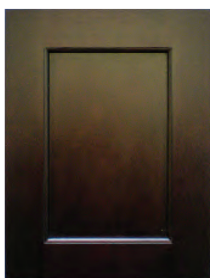

*Wellington  
Espresso*



*Wilmington  
Antique White Glaze*

## Finishes



*Cherry*



*Natural*

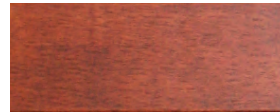

*Cherry Glaze*

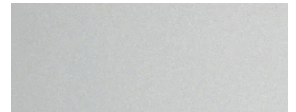

*White*

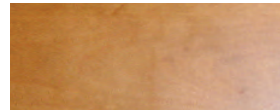

*Cinnamon*



*Antique White*



*Cinnamon Glaze*

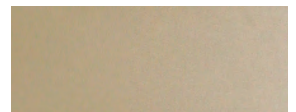

*Antique White Glaze*

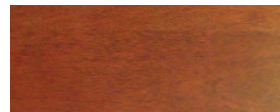

*Cognac Glaze*

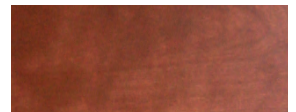

*Hazelnut*



*Ginger Glaze*

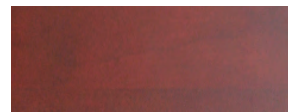

*Port*



*Spice*

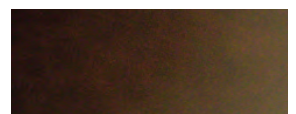

*Espresso*



*Options to enhance products and purchase programs.*

## *Product Options*

Optional upgrades are available to fully customize the look, feel and functionality of our products. Whether it is face frame or frame-less cabinets, solid hardwood dovetail drawer boxes or full extension drawer guides with cushion close, we can tailor our cabinets to meet the needs of any project.



*Solid Hardwood Dovetail Drawer Boxes*



*Full Extension Drawer Guides*



*Face Frame or Frameless Construction*

Century Cabinets, Inc  
ph 678-213-2299  
fx 678-213-2432  
[www.centurycabinetsinc.com](http://www.centurycabinetsinc.com)



*All wood cabinets constructed to provide lasting value.*

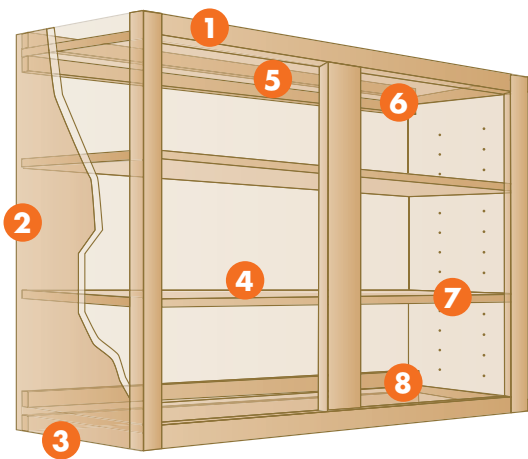

### Wall Unit

- 1 1-1/2" x 3/4" solid hardwood face frame mortised and tenoned
- 2 1/2" pre-finished plywood sides
- 3 1/4" pre-finished plywood back with 1/2" strength stile
- 4 Interior is pre-finished plywood
- 5 1" thick pre-finished plywood hanging rail
- 6 1/2" pre-finished plywood
- 7 3/4" pre-finished adjustable plywood shelf
- 8 1/2" pre-finished plywood bottom



### Base Unit

- 9 3" x 3/4" solid hardwood face frame mortised and tenoned
- 10 High impact corner braces screwed into side and face frame
- 11 1" thick pre-finished plywood hanging rail
- 12 1/2" pre-finished plywood back panel can be used as hanging rail
- 13 Double snap cleat and buckles
- 14 1/2" pre-finished plywood sides
- 15 3/4" pre-finished adjustable plywood shelf
- 16 1/2" pre-finished plywood bottom
- 17 1-1/2" x 3/4" solid hardwood face frame mortised and tenoned
- 18 4-1/2" high by 3" deep toe kick cut-out with 1/2" prefinished plywood toe board

### Drawers

- 19 5/8" pre-finished solid hardwood front, sides and back
- 20 Epoxy coated metal side mount drawer guide
- 21 1/4" pre-finished plywood bottom
- 22 3/4" solid hardwood drawer front

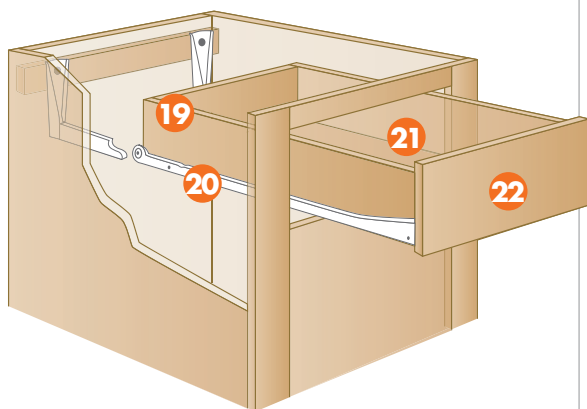

### Doors

- 23 Doors are made with 3/4" solid hardwood frames and 1/2" solid panels.





1235-A Kennestone Cir NW

Marietta, GA 30066

Phone: 678-213-2299

Fax: 678-213-2432

[www.centurycabinetsinc.com](http://www.centurycabinetsinc.com)

email: [info@centurycabinetsinc.com](mailto:info@centurycabinetsinc.com)